

THE SPINNAKER



CRAFTSMAN



TRADITIONAL



TRANSITIONAL

FEATURES:

3 - 5 Bedrooms

2.5 - 3.5 Bathrooms

2,162 - 2,706 sq ft

1st Floor Master Suite,
4th Bedroom/Loft Opt

SALES COUNSELOR: **DIANA JORDAN**

(757) 284-1845

diana@napolitanohomes.com

www.napolitanohomes.com/suffolk/kings-fork-village

All prices, plans, elevations, features, specifications, and materials are subject to change without notice or obligation. Illustrations and floor plans are artist's renderings, not architectural blueprints. Options and extra-cost upgrades such as stone and brick may be shown and may vary by neighborhood. Please consult with your sales counselor prior to writing an offer.



THE SPINNAKER

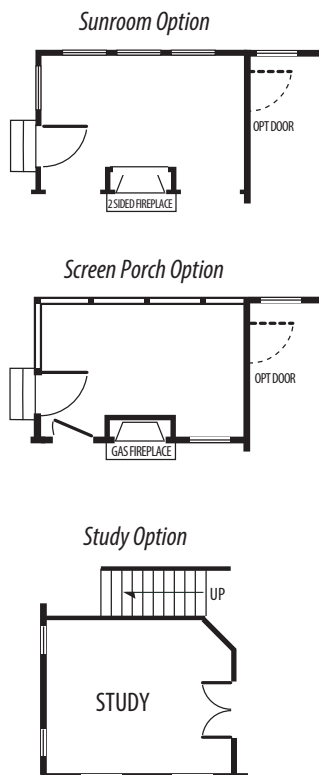
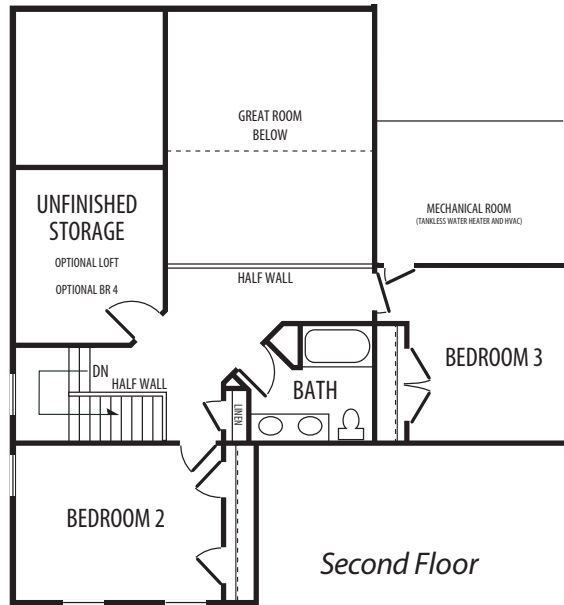
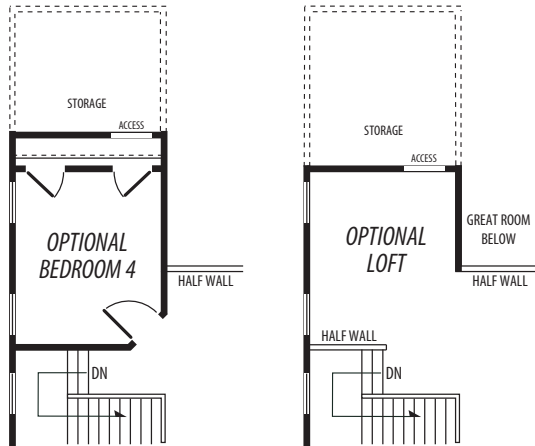
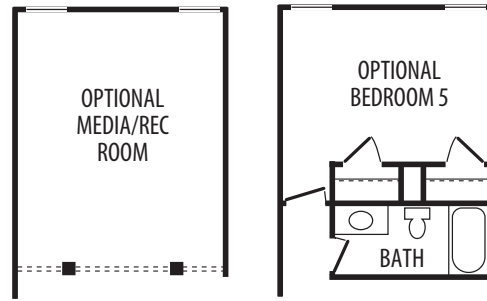

*All floorplans based on Traditional Elevation